

# *Regional Cultural Facilities Dialogue Report*

*Alberta Culture and Community Spirit – October 2009*



Cover photo credits (Clockwise, Left to Right): Galt Museum Archives, EnCana Science Camp - Badlands, AB, The Esplanade, Medicine Hat, AB, Medalta Potteries - Medicine Hat, TransAlta Arts Barns - Interior, Edmonton, AB.



# *Table of Contents*

## *Executive Summary*

In February of 2009, Alberta Culture and Community Spirit undertook a strategic overview of cultural facilities across the province in order to ascertain the state of activity in cultural facilities planning, and to identify current trends and projects in development.

To supplement this work, the Honourable Lindsay Blackett, Minister of Culture and Community Spirit, hosted a series of regional dialogues in June 2009 aimed at gathering information, understanding diverse perspectives and identifying community needs related to cultural infrastructure. Results from the dialogues will assist the department in developing a comprehensive plan for maintaining existing inventory in the province, while deploying resources for new facilities in a visionary and innovative fashion.

A total of 162 individuals attended six dialogues, held in various regions of the province. Participants were responsive to the facilitated sessions, which focused on trends, issues and projects in development. It became clear that there is a tremendous amount of planning work taking place across Alberta, and local and regional communities are actively participating in bringing cultural facilities to the forefront of the agenda at the municipal and provincial levels. Indeed, a total of more than \$2.5 billion in projects were identified as being in the concept, design, or execution stage.

Issues identified by attendees throughout all of the regions had much in common: the challenge presented by life cycle management and aging infrastructure, as many of the anchor cultural facilities were built more than two decades ago; growing demands and space needs and gaps, as communities have grown exponentially in Alberta, and a changing demographic places different requirements on cultural facilities; an emerging emphasis on having smaller, flexible, multi-use and multidisciplinary facilities; and the importance of embracing advances in technology in designing cultural facilities and extending their reach.

Several drivers emerged which must be considered in evaluating cultural facility requirements, including prudent management of financial resources, and capacity for undertaking cultural facilities planning and operations. The discussions also made it clear that there is a diffuse base of information regarding cultural facilities across the province. The dialogues provided an opportunity for stakeholders to share their knowledge and consider ways to begin to work together.

A number of exciting discussions were initiated across the Province that will help to empower communities, and continue to inform and advance the goals of the department in building a thoughtful strategic plan for cultural facilities in Alberta.

## Introduction

Alberta Culture and Community Spirit recognizes that for this goal to become a reality a key component is a vital and responsive network of cultural facilities comprised of government-owned and community-owned venues.

*“...growing attention to cultural infrastructure in recent years has been spurred by a range of factors including economic shifts and restructuring of communities, an aging population, growing diversity, the growth and evolution of artists and the cultural sector and of course, aging infrastructure approaching the end of its life cycle.”*

*[Druxbury, Nancy (Ed.). UNDER CONSTRUCTION: The State of Cultural Infrastructure in Canada, Page 7. Vancouver, BC: Simon Fraser University, 2008. Print, Online ([www.cultureandcommunities.ca](http://www.cultureandcommunities.ca))]*

In February of 2009, the department undertook a strategic overview of existing cultural facilities as well as cultural facility projects in

development across the province. The overarching goals were to ascertain the state of activity in cultural facilities planning, and identify current trends and projects in development.

To supplement the department’s work on cultural facilities, in May 2009 the Honourable Lindsay Blissett, Minister of Culture and Community Spirit, announced that he would host a series of regional dialogues aimed at gathering information, understanding diverse perspectives and identifying community needs related to cultural infrastructure.

Results from the dialogues would inform the department’s long-term approach to cultural infrastructure with a view to articulating a coherent plan for maintaining and enhancing existing inventory in the province, while deploying resources for new facilities in a visionary and innovative fashion.



*Jack Singer Concert Hall, Calgary, AB*



*Northern Alberta Jubilee Auditorium, Under Construction, Edmonton, AB*



*Northern Alberta Jubilee Auditorium, Present, Edmonton, AB*

## ***Background***

*The Spirit of Alberta*, Alberta's cultural policy, attests to the government's understanding of the role culture plays in helping citizens to build stronger communities and improve quality of life.

As is the case across Canada, important developments in cultural facilities in Alberta have often been precipitated by the imminent celebration of provincial or national centenaries, and an accompanying surge of civic or national pride. Following, is a brief history of major cultural infrastructure developments in Alberta.

### ***1950's and 60's***

- The Alberta Jubilee Auditoria, one each in Calgary and Edmonton, were built to celebrate the 50th anniversary of the province in 1955 (opening in 1957).
- In 1965, Edmonton community leaders bought the old Salvation Army Citadel for \$100,000 and established The Citadel Theatre.
- In 1966, the Glenbow Museum was launched with the generous donation of Eric Harvey's collection of art and artefacts from around the world.

### ***1970's and 80's***

A further significant investment in cultural infrastructure occurred leading up to, and following, the 75th anniversary of the province in

1980. This gave rise to a majority of anchor cultural facilities existing in the province today, particularly outside the major urban centres.

- Major Cultural/Recreation Facility Development Grant Program was established, running from 1975 through 1985, with a total provincial investment \$66 million.
- The new Citadel Theatre opened in Edmonton in 1976.
- The Calgary Centre for Performing Arts (EPCOR CENTRE) opened in 1985.
- The Royal Tyrrell Museum of Palaeontology also opened in 1985.

### ***1990's and 2000's***

Investment in cultural facilities was consistent in the 1990's, while the new millennium saw the return of increased attention and support which grew steadily in the first decade.

- The Winspear Centre for Music opened in Edmonton in 1995.
- The Esplanade Arts and Heritage Centre opened in Medicine Hat in 2005.

As part of Alberta's Centennial celebrations in 2005, significant effort was made to invest in capital improvements to many of the province's museums, parks and cultural facilities. This included a complete refurbishment of the two Jubilee Auditoria and the creation of the Esplanade Arts and Heritage Centre in Medicine Hat, largely through the auspices of the Centennial Legacy Project Fund. This onetime \$314 million grant program funded 103 community projects, many of which were cultural infrastructure initiatives.

Cultural facilities investment has continued in recent years. *The Government of Alberta Annual Report* for 2007-08 notes in its discussion of major initiatives that Recreation and Culture enjoyed a 75% increase in allocation from the prior year, 2006-07:

*“This included a major increase in capital funding for community facilities, through a new two-year (\$140M in each year) Major Community Facilities Program and increased capital maintenance funding for provincial parks and protected areas. The Spirit of Alberta, Alberta’s cultural policy was released, which provides a decision-making framework for cultural support, growth and development.”*

Strong government support for cultural facilities across Alberta continues. Over the past two years provincial cultural facility investments include:

- Art Gallery of Alberta, Edmonton, scheduled to open in January 2010;
- Heritage Park Historical Village, Calgary;
- Plamondon Community Centennial Cultural Concert Centre, scheduled to open April 2010;
- Medicine Hat Clay Products National Historic District;
- Telus World of Science, Calgary; and
- Olds College Fine Arts and Multi-media Centre, opened in 2009

The Government of Alberta is committed to the development of a well managed, financially robust and sustainable cultural sector. The province provides financial assistance for cultural facilities through a number of grants and funding envelopes - initiatives which have proven successful in helping to deliver affordable, quality cultural experiences for urban and rural communities.

Provincial capital and operating contributions to culture in Alberta increased from \$198.5 million in 2003-04 to \$325 million in 2006-07, an increase of 64%, while Federal culture operating and capital contributions to the province decreased by 28% from \$32.6 million to \$23.4 million over the same time period. In 2003-04, total municipal funding for culture in Alberta was \$186 million which, by 2006-07, had increased by 22% to \$227 million.

*Medalta Potteries, Medicine Hat, AB*



## *Process*

For the purpose of these dialogues the province was divided into six regions: Northwest, Northeast, Edmonton and area, Central, Calgary and area, and Southern Alberta. This was an effective mechanism for engaging with local partners in mapping long-term cultural facility developments.

Invitation lists were initially developed by Alberta Culture and Community Spirit in consultation with the Premier's Council on Arts & Culture, then reviewed for comprehensiveness and further expanded by the project facilitators.

Invitations were then prepared and distributed by the department. Information providing context for the dialogue and links to background reading materials were distributed to participants at least one week in advance of each of the regional dialogues.

The invitation to participate was based on the following broad criteria:

- Invitees would have direct cultural facility interest(s) especially in heritage, the arts and cultural industries (especially film & television), multicultural, and not-for profit sectors including private foundations with a cultural facility interest.
- Invitees would have the most insight into current and future cultural facility needs in each region and being able to identify opportunities to enhance current and future facility provision.
- Invitees would represent equitable regional representation spanning the broad spectrum of culture (arts, heritage, nonprofit and community organizations).
- Invitees would provide a demonstrated need for cultural infrastructure (new build or facility enhancements) or a requirement which will enhance their organizational capacity/service delivery for their community.

At each dialogue, Minister Blackett spoke about the importance of the feedback being sought, what is being proposed, the scope of influence and the expected benefits.

Attendees were asked to summarize the organizations they represented and their specific interest in attending. The sessions focused on trends and issues associated with cultural facilities facing participants, the needs in their communities and the identification of cultural infrastructure developments.

For invitees who could not attend the sessions but expressed interest in contributing to the dialogue, an online survey was made available from July 5 - 31, 2009.

Overall, a total of 162 people attended these six regional sessions and eleven online responses were received.

## *Six Regional Dialogues Consolidated – Key Findings*

In advance of each session, a backgrounder was sent to all participants. The information piece was intended to provide them with an overview of issues and trends related to cultural infrastructure in Canada.

As part of the backgrounder, the special 2009 edition of the Creative City Network's Newsletter provided a summary of key issues currently facing cultural infrastructure. The newsletter was based on the research work of the Centre of Expertise on Culture and Communities (CECC), a cultural research and development project at Vancouver's Simon Fraser University.

CECC had previously published *UNDER CONSTRUCTION: The State of Cultural Infrastructure in Canada* in August 2008.

General issues identified in the newsletter included the following:

- Aging infrastructure/condition issues;
- Space needs and gaps;
- (In)stability of accommodation;
- Maximizing productivity of public investment;
- The state of knowledge;
- Fragmented policy-funding.

Links to this newsletter and CECC's report were provided to participants prior to the sessions. During the session, the above list was referred to as participants discussed issues and trends affecting their communities as they relate to cultural facilities.

Despite clear distinctions that come about as a result of differences in geography, population and demographics, the regional dialogues revealed considerable similarities with respect to trends and issues facing the cultural sector in all regions.



*EnCana Science Camp, Badlands, AB*

## SPACE NEEDS AND GAPS

Participants across the province identified the growing demand in their communities for cultural facilities. They spoke to the recent, and for the most part continued, lack of affordable work and living spaces for artists, particularly in the two largest urban centres. They identified the growing need for multi-purpose space and the competing demands of single-use versus multi-use spaces.

Interestingly, it was a behind-the-scenes facility issue that received significant attention throughout several of the regional sessions. Participants cited the lack of storage capacity for displays, archives and collections as a serious infrastructure issue.



*Winspear Centre, Edmonton, AB*

## MULTI-USE/MULTI-DISCIPLINARY

As mentioned above, participants strongly echoed the current research on the increasing demand for flexible multi-use and multi-disciplinary facilities that could serve as cultural hubs or incubators. It was noted in several sessions that facility operators struggling to maintain their current assets were unable to respond to these new trends and demands from the growing cultural sector.

## LIFECYCLE

*“Cultural assets experienced the greatest decline during the 1990’s and well into the 2000’s, with the period from 1995 to 2000 showing the largest drop. Since the early 1990’s, Canada’s cultural infrastructure has been aging more rapidly than at any time since 1961. The aging infrastructure is attributable to insufficient investment that would maintain the value of the assets.”*

[Druxbury, Nancy (Ed.). UNDER CONSTRUCTION: The State of Cultural Infrastructure in Canada, (Appendix) Pages 36-38. Vancouver, BC: Simon Fraser University, 2008. Print, Online ([www.cultureandcommunities.ca](http://www.cultureandcommunities.ca))]

As noted earlier, the majority of Alberta’s cultural infrastructure was built between the late 1950’s and 1985. Across the regional dialogues, the issue of aging infrastructure was strongly associated with both government-owned and community-owned facilities.

Participants noted that the issue of aging infrastructure has a negative impact not only on the physical well-being of a structure, but also on an organization’s ability to manage the ongoing capital requirements and programming needs without access to public funds to assist with facility maintenance. They also noted that an outdated facility hampers the ability of its operators to respond to the emerging trends noted in the various regions.

## PARTNERSHIPS

In conjunction with the demand for multi-purpose and multi-discipline spaces is the increased focus among participants on forming both formal and informal collaborations and partnerships in order to achieve their goals related to infrastructure and community enhancement. Session participants identified possible partnerships among public sector funders, between sectors (i.e. creative industries and non-profit arts organizations) among organizations and between and among the private, public and non-profit cultural sectors.

## SHIFTING DEMOGRAPHICS

Participants identified trends resulting from changing demographics across the province, such as increased in-migration. This in-migration, in turn, generates the need for access to infrastructure for cultural participation that may not have existed 10 years ago. Participants also spoke of the increased immigration activities in the province and the opportunities and challenges that exist to increase participation of these new Albertans.



*Jack Singer Concert Hall, Calgary, AB*

Participants also noted that an aging population is having great influence on society as a whole, and could be pushing substantially greater opportunities for cultural participation as they age. Their thinking appears to echo that of demographer David Foot who, in his 2002 book *Boom, Bust & Echo*, argued that the future planning and funding of infrastructure should take into account the aging population. He commented that as our population ages, in particular the huge baby-boomer demographic, there will be a move away from sports and toward increased participation in other cultural activities.

## TECHNOLOGY

Participants spoke to the rapid rate of changing technology and the challenges of integrating new technology into outdated infrastructure. Several commented on what they perceive as a “hunger” for interactive cultural activities from their audiences. Some also noted that they feel constrained by their own lack of expertise in the area of technology and its uses with respect to audience and cultural professional engagement, with the consequences that they may neglect to include technology at its most useful and appropriate levels when planning infrastructure upgrades or developments.

Conversely, they also spoke of the freedom and accessibility technology has provided a growing number of cultural professionals and creative organizations, enabling them to self-produce and self-market their cultural products.

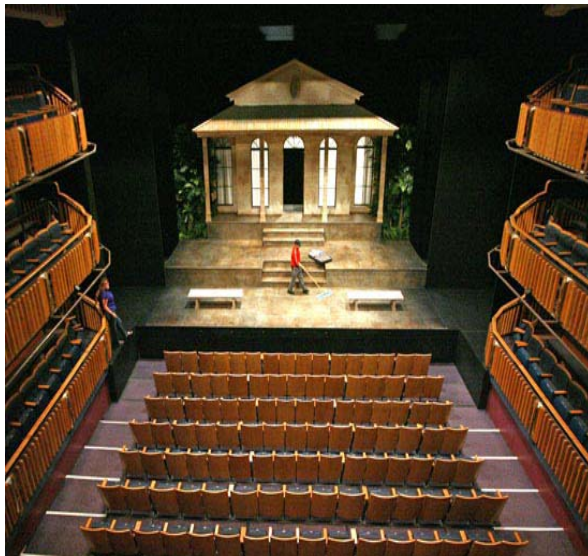

*Martha Cohen Theatre, Calgary, AB*

*“We want to involve Red Deer citizens, business and cultural champions in a wide ranging conversation about culture and quality of life in Red Deer... Citizens agree that culture is a major contributor to quality of life, and this process is about fostering dialogue between the business community and the culture community to create a common language about the social and economic benefits of culture.”*

Kristina Getz, former Culture Superintendent for The City of Red Deer, in October 9, 2007 press release on the launch of the progress review of the City's *Community Culture Master Plan*. Red Deer's *Community Culture Vision* was completed in 2008 and can be found at [www.reddeer.ca](http://www.reddeer.ca)

## **GROWING ROLE OF MUNICIPALITIES**

Participants were very enthusiastic about the growing interest and commitment municipalities in Alberta are taking in cultural infrastructure planning. Spurred on by the creative cities movement, Alberta's municipalities are working to ensure cultural infrastructure is on the civic agenda.

A number of communities had either completed, or were in the process of developing plans, related to cultural infrastructure. These included Grande Prairie, Calgary, Edmonton, Lethbridge, Red Deer, the tri-county region of Spruce Grove, Stony Plain and Parkland County, Medicine Hat, and St. Albert. In addition, smaller and very active communities are undertaking their own planning initiatives in an effort to define their unique cultural identities.



# *Summary of Regional Dialogues*

## *The Northwest Alberta Region*

The Northwest Alberta Region cultural facilities dialogue was held in Grande Prairie on Friday, June 19, 2009. There were a total of 23 attendees.

Participants noted that the region has a strong history of interest and involvement in cultural activities. Attendees expressed pride in their willingness to partner with others in the community and collaborate in order to advance cultural projects such as the new Montrose Cultural Centre, which is home to the Prairie Art Gallery and the Grande Prairie Public Library. This joint initiative arose following the development of the Grande Prairie Cultural Opportunities and Facilities Business Plan in 2003, which encouraged partnerships and identified a number of key cultural facilities initiatives for action.

Participants discussed priorities for their region with respect to cultural facilities.

### *They noted the importance of having:*

- Multi-use community halls/cultural centres in order to respond to the changing nature of the communities being served;
- Preservation of archives;
- Performing arts facilities;
- Museums/heritage sites (many of which require ongoing maintenance and restoration).

### *They felt that all projects should:*

- Be relevant to those who live in the region;
- Demonstrate enduring quality and design;
- Be environmentally conscious;
- Be interactive (deploy technology in an engaging fashion);
- Respect the heritage and history of the region;
- Encourage linkages and the sharing of skills and resources;
- Encourage and support cultural education.

In addition, participants introduced the idea of having hubs that could serve as gathering places. For instance, the “60- minute hub” with access to information technology, facilities and operations knowledge, professional development opportunities, and facilitate social and virtual connectivity.



*Montrose Cultural Centre, Grande Prairie, AB*

Participants identified a number of projects being contemplated or under development in the region.

- Montrose Cultural Centre

*Timeline: Short term*

---

- River of Death & Discovery Dinosaur Interpretive Centre

*Timeline: Medium term*

---

- Cadotte Lake Cultural Community Centre

*Timeline: TBD*

- Demmit Centre for Community Development

*Timeline: TBD*

- Grande Prairie Museum Expansion

*Timeline: TBD*

- Grande Prairie Live Theatre refurbishment

*Timeline: TBD*

- Grouard Historical Village

*Timeline: TBD*

- McNaught Homestead

*Timeline: TBD*

## *The Northeast Alberta Region*

The Northeast Alberta Region cultural facilities dialogue was held in Fort McMurray on June 24, 2009. There were a total of 15 participants.

At this discussion, participants were highly cognizant of the unique situation in which they find themselves in this region, one of the fastest growing areas in Canada.

The region is also unique in that there is significant immigration from other parts of Canada (there is an entire subsection of the region's population which prides itself on being from Newfoundland, for example) as well as other countries, as a large workforce is drawn to the opportunities afforded by the vast oilsands projects.

This means that only a small portion of the cultural users are long-time residents of Fort McMurray or environs, leading to many subsets in terms of culture and cultural practices. In addition, there is simply no excess space available for cultural usage, as real estate is fully deployed for both residential and commercial purposes in addition to being very costly.

Participants discussed priorities for their region with respect to cultural facilities.

### *They noted the importance of having:*

- Expanded or new amphitheatre / facilities in the Thickwood / Timberlea multi-use facility;
- A visual arts centre with studios and shared facilities for artists, as well as public exhibition space for the visual arts;
- A multi-cultural centre to address the trend towards diversity in the population, and to bring cultural groups together;
- A new, large performing arts centre;
- A central festival/celebration space for all seasons, all cultures.

### *Participants identified a number of projects being contemplated or under development in the region:*

- ANZAC Rural South Multi-Use facility  
*Timeline: Medium term*
  - Fine Arts Partnership - Ft. McMurray Catholic School Board school expansion  
*Timeline: Medium term*
  - Heritage Park Re-development  
*Timeline: Medium term*
  - Thickwood/Timberlea Multi-Use facility  
*Timeline: Medium term*
- 
- Conklin Community Centre  
*Timeline: Long term*
  - Heritage Marine Park  
*Timeline: Long term*
  - Historic Park Museum  
*Timeline: Long term*
  - Interpretive Centre  
*Timeline: Long term*
  - Regional South Facility  
*Timeline: Long term*



*Fort McMurray  
Consultations,  
Fort McMurray, AB*

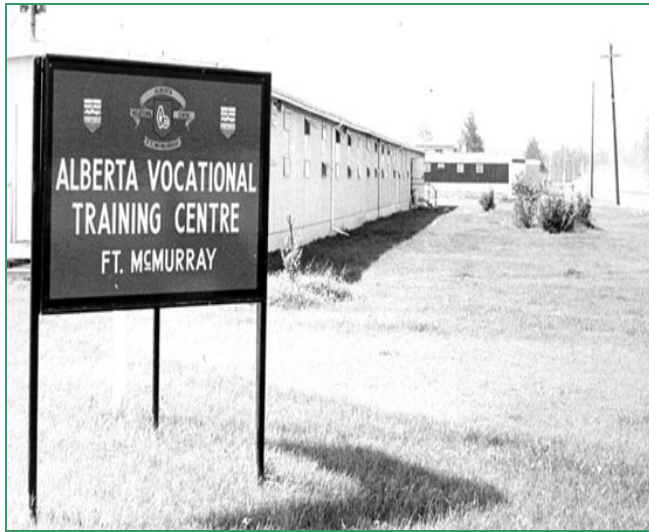

*Keyano College, 1965*



*Keyano College, Present*

*“A studio is simply a dedicated space for the assemblage of materials and the creation of art objects and the sharing of ideas. It might be a painter’s easel, or a weaver’s loom, or a jeweler’s bench, or a sculptor’s chisels. The space reflects the needs of the creators in the community. When creators come together, their collective resources of skills and vision launches programs, classes, exhibitions, and links to the larger community.”*

Robin Smith-Peck & Garry Berteig, Keyano College.

## *The Edmonton Region*

The Edmonton Region cultural facilities dialogue was held on Thursday, June 11, 2009. There were a total of 32 attendees.

Participants noted that Edmonton and the surrounding region has a long history of valuing arts and heritage in the community, and supporting planning for cultural facilities.

Participants referred to the *Edmonton Municipal Cultural Plan* completed in 2008, which supports the creation of an organization “dedicated to finding, developing, and managing space for the arts in Edmonton.” This organization, known as ArtsHab, is in development at the present time.

In addition, Spruce Grove, Stony Plain and Parkland Country completed a tri-municipal study in April 2009 which includes an assessment of existing facilities and a needs assessment for developing priorities in recreation and cultural facilities.

The top priorities identified for cultural facilities were:

- performing arts theatre space;
- library space;
- art display spaces;
- museum spaces; and
- arts and crafts studios.

In the broader regional discussion group, participants noted the importance of the following:

- Maintenance and improvements to Varscona Theatre, Citadel Theatre, Winspear Centre for Music, Roxy Theatre, Reynolds Museum and Catalyst Theatre;
- Art Gallery of Alberta;
- Museum for City of Edmonton;
- Archives (Provincial, City of Edmonton);
- Multi-purpose facilities, especially in rural areas; and
- Royal Alberta Museum



*Royal Alberta Museum, Edmonton, AB*

*“ArtsHab’s (Arts Habitat Association of Edmonton) original vision is to use the power of the arts as a catalyst for developing neighbourhood and community identity an activity, and to be an active and effective partner in city revitalization and development projects...”*  
[Arts Habitat Association of Edmonton. News. Web. 8 Oct. 2009. ([www.artshab.com/news\\_details.htm](http://www.artshab.com/news_details.htm))]

Participants identified a number of projects being contemplated or under development in the region:

- Art Gallery of Alberta

*Timeline: Short term*

- theARTery Refurbishment

*Timeline: Short term*

- Civic Community Centre - Sherwood Park

*Timeline: Short term*

- Citadel Theatre Upgrades

*Timeline: Short term*

- Edmonton Jazz Society Renovations

*Timeline: Short term*

- Edmonton Mennonite Centre

*Timeline: Short term*

- Edmonton Musical Theatre Facility

*Timeline: Short term*

- Exhibition Park Upgrade - Stony Plain

*Timeline: Short term*

- Horizon Stage Renovation - Spruce Grove

*Timeline: Short term*

- Maclab Centre for Performing Arts - Leduc

*Timeline: Short term*

- Nina Haggerty Centre for Arts

*Timeline: Short term*

- Town library Expansion - Stony Plain

*Timeline: Short term*

- 
- Arch at Hawrelak Park

*Timeline: Medium term*

- Childrens Theatre/Senior Centre - St. Albert

*Timeline: Medium term*

- Cultural Park - St. Albert

*Timeline: Medium term*

- Fort Edmonton Park

*Timeline: Medium term*

- ihuman Youth Society Studio

*Timeline: Medium term*

- Jubilee Park - Spruce Grove

*Timeline: Medium term*

- Musee Heritage Museum - St. Albert

*Timeline: Medium term*

Winspear Centre for Music Upgrades

*Timeline: Medium term*

- Varscona Theatre Renovations

*Timeline: Medium term*

- 
- Arden Theatre Seat Replacement - St. Albert

*Timeline: Medium to Long term*

- CKUA Radio Network Facility

*Timeline: Medium to Long term*

- 
- Alberta Craft Council Gallery

*Timeline: Long term*

- Catalyst Theatre Facility

*Timeline: Long term*

- Edmonton Opera Centre

*Timeline: Long term*

- Edmonton Opera Rehearsal Hall

*Timeline: Long term*

- Film & Video Arts (FAVA) Facility

*Timeline: Long term*

- Roxy Theatre Renovations (Theatre Network)

*Timeline: Long term*

- 
- A.J. Ottewell Community Centre - Strathcona County

*Timeline: TBD*

- Capoeira Academy Facility

*Timeline: TBD*

- Community Centre - Stony Plain

*Timeline: TBD*

- Concrete Theatre Facility

*Timeline: TBD*

Participants identified a number of projects being contemplated or under development in the region – CONTINUED

- Festival Place Expansion - Sherwood Park

*Timeline: TBD*

- Michif Institute/Juneau House Renovations  
- St. Albert

*Timeline: TBD*

- Royal Alberta Museum

*Timeline: TBD*

- Workshop West Renovations

*Timeline: TBD*

## *The Central Alberta Region*

The Central Alberta Region cultural facilities dialogue was held in Red Deer on Wednesday, June 17, 2009. There were a total of 29 attendees. Participants noted that the region had grown exponentially over the past decade, and expressed the concern that such growth is placing a strain on cultural facilities infrastructure.

The City of Red Deer has undertaken a Recreation, Parks and Culture Community Asset Needs Assessment, which clearly identifies strategies for strengthening the mix and quality of cultural amenities.

### *Among the priorities in the plan:*

- Development of a performing arts theatre that includes a concert hall in the Riverside district;
- Re-development of museum and archive spaces in partnership with Red Deer Museum Society; and
- Development of a new festival site

*A number of these priorities were reinforced in discussion with participants, who identified the following as being of importance in the region:*

- Performing arts theatre/concert hall for Red Deer (1500-2000 seats);
- Enhancements to Red Deer College (public space for permanent art collection, larger community performing arts centre, visiting artist studios), and/or community exhibition space for visual arts;
- Space for participatory activity by Aboriginal groups in Wetaskiwin and Hobbema;
- Infrastructure in a permanent space in small communities to house displays/archives/associations which preserve history, especially community history;
- Festival site for large festivals, with amenities;
- Public market and artist studios in old transit barns (Red Deer);
- 2015 Danish Canadian National Museum;
- Addition to Innisfail Museum; and
- More multi-purpose facilities to bring together multiple disciplines (performing arts, visual arts, literary arts, electronic media, etc.), educational space, and heritage initiatives; which could also be used for community and commercial uses.



*Red Deer Museum & Art Gallery, Red Deer, AB*

Participants identified a number of projects being contemplated or under development in the region:

- Addition to Innisfail Museum

*Timeline: Short term*

- Explore options for a new festival site - Red Deer

*Timeline: Short term*

- German Canadian Club Facility - Red Deer

*Timeline: Short term*

*once funding has been secured*

- Red Deer and District Museum

*Timeline: Short term*

- 
- Camrose Performing Art Centre

*Timeline: Medium Term*

- Performing Arts Facility with Concert Hall - Red Deer

*Timeline: Medium term*

- 
- Danish Canadian Museum - Town of Dickson

*Timeline: Long term*

- 
- Aviation Museum - Red Deer

*Timeline: TBD*

- Badlands Community Facilities - Drumheller

*Timeline: TBD*

- Bailey Theatre Restoration - Camrose

*Timeline: TBD*

- Drayton Valley Museum Expansion

*Timeline: TBD*

- Innisfail Library

*Timeline: TBD*

- Re-development of old rail yards into cultural district Public Exhibition space for Red Deer College permanent art collection

*Timeline: TBD*

- Relocation of public market to former transit barns - Red Deer

*Timeline: TBD*

- Shared participatory space for Aboriginal communities in Hobbema and Wetaskiwin

*Timeline: TBD*



*Royal Tyrrell Museum, Drumheller, AB*

## *The Calgary Region*

The Calgary Region cultural facilities dialogue was held on Monday, June 22, 2009. There were a total of 44 attendees.

Calgary participants commented on the pent-up demand for cultural facilities in Calgary and area, due to population expansion, but also due to an increasing focus on cultural facilities planning in the region. It was noted that the City 'has come of age', and there is a growing movement to ensure there is a mature, exciting cultural landscape which adequately reflects this evolution.

Calgary Arts Development Authority has developed a cultural facilities strategy and created a community committee to review applications and make recommendations for projects to be supported with provincial Municipal Sustainability Initiative funds allocated to the City of Calgary.

Participants noted the importance of having:

- Arts incubators;
- Functional, multi-purpose facilities that could include, for example, rehearsal space, shops, and presentation space;
- Live/work affordable housing for artists and cultural workers;
- Contemporary visual arts gallery for Calgary; and
- Administrative/production space with office, storage, and creation space.

*Calgary Consultations, Calgary, AB*



Participants identified a number of projects being contemplated or under development in the region:

- Banff Centre Revitalization

*Timeline: Short term*

- Calgary Arts Incubator

*Timeline: Short term*

- Decidedly Jazz Dance School - Calgary

*Timeline: Short term*

- International Avenue Arts & Culture Centre - Calgary

*Timeline: Short term*

- Media & Visual Arts (MaVa) Facility - Calgary

*Timeline: Short term*

- Mount Royal Conservatory - Calgary

*Timeline: Short term*

- National Music Centre at the King Eddy

(Cantos Music Foundation) - Calgary

*Timeline: Short term*

- Olympic Plaza/Paget Park Development - Calgary

*Timeline: Short term*

- Pumphouse Theatre Expansion - Calgary

*Timeline: Short term*

- University of Calgary Nickle Arts Museum Expansion

*Timeline: Short term*

- 
- Telus World of Science - Calgary

*Timeline: Short to Medium term*

- 
- Alberta Ballet Facility - Calgary

*Timeline: TBD*

- Alberta College of Art & Design

New Campus - Calgary

*Timeline: TBD*

- Alberta Craft Council Gallery - Calgary

*Timeline: TBD*

- Aerospace Museum of Calgary Renovation

*Timeline: TBD*

- Art Gallery of Calgary Studios - Calgary

*Timeline: TBD*

- Artmobile Expedition Gallery and Studio - Calgary

*Timeline: TBD*

- Brazilian Community Association of Alberta

- Multi-purpose Facility - Calgary

*Timeline: TBD*

- Calgary Arts Resource Society Production and Storage Space

*Timeline: TBD*

- Calgary Blues Music Association Offices - Calgary

*Timeline: TBD*

- Calgary Community Band Facility Association - Rehearsal Space

*Timeline: TBD*

- Calgary Creative Hub

*Timeline: TBD*

- Calgary Folk Music Festival Facility

*Timeline: TBD*

- Calgary Glass Initiative Hot Studio

*Timeline: TBD*

- Calgary Opera Cultural Centre

*Timeline: TBD*

- Calgary Public Library

*Timeline: TBD*

- Calgary Stampede Foundation

Youth Campus - Calgary

*Timeline: TBD*

- Calgary Stampede Main Street

*Timeline: TBD*

- Canadian Cultural Imperialism Gallery

- Calgary

*Timeline: TBD*

- Cochrane Arts Centre

*Timeline: TBD*

- Community Arts Centre - Calgary

*Timeline: TBD*

- Contemporary Arts Centre - Calgary

*Timeline: TBD*

Participants identified a number of projects being contemplated or under development in the region - CONTINUED:

EPCOR CENTRE - Arts Centre  
Transformation Project

*Timeline: TBD*

- Friends of Georgina Thompson Art Centre  
- Calgary

*Timeline: TBD*

- Glenbow Museum Expansion - Calgary

*Timeline: TBD*

- Ground Zero Theatre Upgrades - Calgary

*Timeline: TBD*

- Heritage Park - Education Centre and Canmore Opera House  
Renovation

*Timeline: TBD*

- La Caravan Dance Theatre Facility - Calgary

*Timeline: TBD*

- New Gallery - John Snow House Renovations - Calgary

*Timeline: TBD*

- Performing Arts Lodge (PAL) Residence  
- Calgary

*Timeline: TBD*

- Rosebud Centre Phase 1 & 2 - Rosebud

*Timeline: TBD*

- Stride Art Gallery - Calgary

*Timeline: TBD*

- Truck Gallery and offices - Calgary

*Timeline: TBD*

- University of Calgary Rozsa Centre Expansion

*Timeline: TBD*

- Webber Academy Theatre - Calgary

*Timeline: TBD*

- Youth Singers of Calgary Facility

*Timeline: TBD*



*The Banff Centre, Banff, AB*

## *The Southern Alberta Region*

The Southern Alberta cultural facilities dialogue was held in Lethbridge on Saturday, June 27, 2009. There were a total of 19 attendees.

Attendees noted that Southern Alberta is “*connected to its environment, with a desire to preserve and protect it.*” There is a highly collaborative approach to undertaking cultural planning in the region.

Participants from the City of Medicine Hat reported that the community has fulfilled its arts and cultural requirements as identified in a needs assessment completed seven years ago. This assessment resulted in the construction of the Esplanade Arts and Heritage Centre. The budget was \$42 million and the project was completed in 2005.

Participants from Lethbridge referenced the Lethbridge Recreation and Cultural Facilities Master Plan, prepared in 2007. Using the ‘Choosing by Advantages’ process, \$120 million in possible projects were recommended. In the area of cultural facilities, projects include:

- Community arts centres (possible expansion to Bowman Arts Centre, and renovation of an additional facility in Lethbridge);
- Multi-cultural centre (new);
- Nature interpretive centres (Helen Schuler Coulee Centre);
- Performing arts centre (upgrades to Yates Memorial Centre);
- Visual arts facility (expansion to Southern Alberta Art Gallery); and
- Fort Whoop-Up Interpretive Centre (upgrades).

*A number of these priorities were reinforced in discussion with participants, who identified the following as being of importance in the region:*

- Museum of the Highwood in High River;
- Multi-cultural centres and community arts spaces;
- Performing arts centre and visual arts space in Lethbridge;
- Improvements to Empress Theatre in Fort MacLeod;
- Film/new media centre or centres; and
- Broad based facilities to provide space for a mix of cultural activities, storage, presentation and creation work.

*The Esplanade, Medicine Hat, AB*

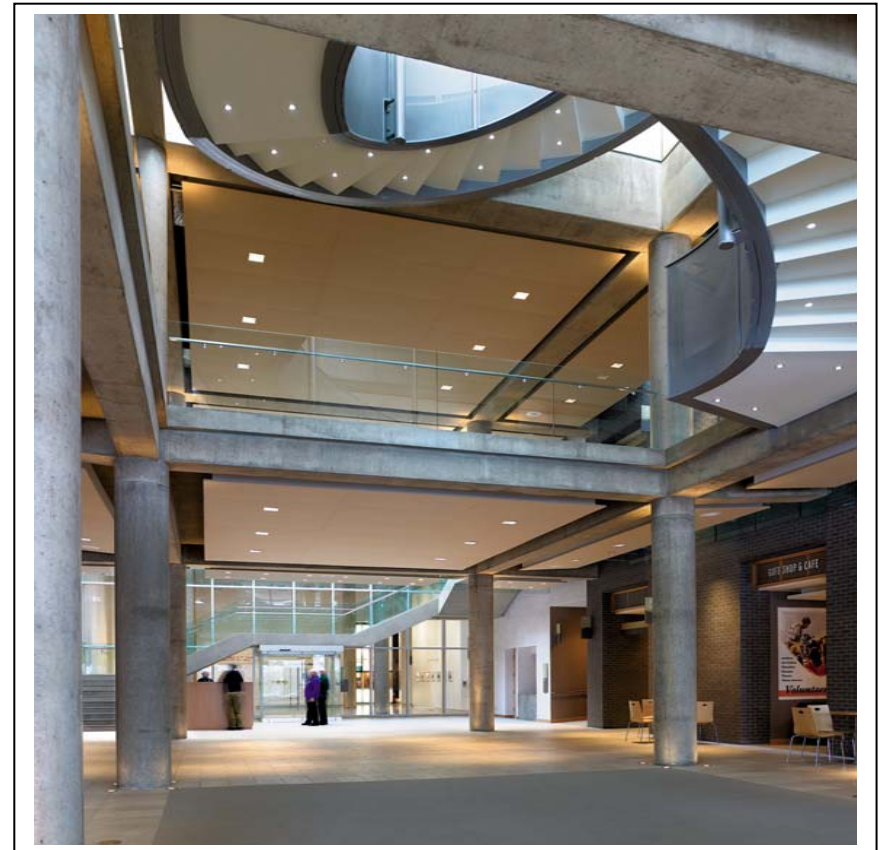

Participants identified a number of projects being contemplated or under development in the region:

- Community Arts Centre - Lethbridge  
*Timeline: TBD*
- Enmax Centre major Renovation & Expansion - Lethbridge  
*Timeline: TBD*
- Fort Whoop Up Upgrades & Expansion - Lethbridge  
*Timeline: TBD*
- Helen Schuler Coulee Centre Renovation - Lethbridge  
*Timeline: TBD*
- Multicultural Heritage Centre (Replace or Renovate Bill Kergan Centre) - Lethbridge  
*Timeline: TBD*
- Nikka Yuko Japanese Gardens Renovation - Lethbridge  
*Timeline: TBD*
- Nord-Bridge Seniors Centre Renovation - Lethbridge  
*Timeline: TBD*
- Performing Arts Centre Master Plan - Lethbridge  
*Timeline: TBD*
- Southern Alberta Art Gallery Expansion - Lethbridge  
*Timeline: TBD*
- West Lethbridge Centre/Crossings Branch - Lethbridge  
*Timeline: TBD*



*Nikka Yuko Japanese Garden, Lethbridge, AB*

## *Epilogue*

For over five decades, Albertans have made culture and cultural infrastructure an integral part of their lives, resulting in a thriving cultural sector and a vibrant province. The regional dialogues hosted by Minister Blackett in June of 2009 arose from a desire on the part of the Government to increase province-wide discussion on cultural facilities, and encourage interaction between the province and the stakeholders most closely associated with the development, maintenance, and programming of those facilities.

*Emerging from these dialogues were three principle themes of:*

- *addressing the requirements of aging infrastructure while providing for emerging needs and exponential growth in Alberta's communities;*
- *recognizing the impact of changing cultural practices on the design and role of facilities;*
- *and developing effective collaborations and partnerships.*

Ultimately, the regional dialogues have enabled the department of Alberta Culture and Community Spirit to glean vital information about unique cultural facility needs from communities across Alberta. This information is critical to creating a process that will enable the department to make informed recommendations on capital funding of cultural facilities. The current climate of economic constraint has further proved the need for funding decisions that are well-guided. Ultimately, these dialogues will inform the development of a cultural facilities capital planning framework.



*TransAlta Arts Barn, Edmonton, AB*

## **Appendix:**

### **Regional Dialogues – Attendees**

#### **Northwest Alberta**

Beaverlodge Cultural Centre – Marjorie Henn  
Centre for Creative Arts – Canadace Hook  
City of Grande Prairie – Lois Harper, Greg Scerbak, Dwight Luguay  
Demmitt Cultural Society – Peter Von Tiesenhjausen  
Fort Dunvegan Historical Society – Dave Cummings  
Grande Prairie Farmers Market – Susan Picard  
Grande Prairie Live Theatre – Rick Hyrciuk  
Grande Prairie Museum – Trenton Parrott, Campbell Ross  
Grande Prairie Wapiti MLA – Wayne Drysdale  
Municipal District of Big Lakes – Jeff Renaud  
Premier’s Council on Arts & Culture – Tom McCabe,  
Brad Hembroff, Audrey Luft, Robert Steven  
Peace River Municipal Library – Linda Prudholme-Warrior  
Peace River Museum and Archives – Laura Gloor  
Prairie Art Gallery – Robert Steven  
South Peace Regional Archives – Mary Nutting, Irene Nicolson  
The Societie Historique de Smoky River – Suzanne Maisonneuve  
Town of High Prairie – Brian Holmberg

#### **Northeast Alberta**

Fort McMurray Catholic Schools – Kim Jenkins  
Fort McMurray – Wood Buffalo Arts and Crafts Guild – Margie Cunningham  
Fort McMurray – Wood Buffalo Constituency Representative – Vaughn Jessome  
Keyano College – Ann Everatt  
Keyano Events Wood Buffalo – Russell Thomas  
Keyano College Foundation – Cindy Amerongen, Angele Dobie  
Keyano College Visual Arts – Garry Berteig, Robin Smith Peck

Nistawoyou Friendship Centre – Marvin McDonald  
Northern Alberta Development Council – Dave Kirschner  
Regional Municipality of Wood Buffalo – Councillor Mike Allen  
Regional Municipality of Wood Buffalo – Koralee Samaroden, John Mulhall,  
Glen Smith

#### **Edmonton and Area**

Alberta Craft Council – Tom McFall  
Alberta Infrastructure – Joanna Rowan Connors  
Alberta Museums Association – Anne Hayward, Alexandra Hatcher  
Alberta Music Industry Association – Kennedy Jenson, Courtney Boyd  
Archives Society of Alberta – Debby Shocter  
Art Gallery of Alberta – Catherine Crowston  
Arts & Heritage Foundation of St. Albert – Ann Ramsden  
Arts Habitat Association of Edmonton – Linda Huffman  
Catalyst Theatre – Guido Tondino  
City of Fort Saskatchewan – Richard Gagnon  
City of St. Albert – Gail Barrington Moss  
CKUA Radio – Ken Regan  
Edmonton-Glenora MLA – Honourable Heather Klimchuk  
Edmonton Mennonite Centre for Newcomers – Rispah Tremblay  
Grouard and Area Historical Society – Louis Bellrose, Peral Sandor  
Horizon Stage – Lawrie Seligman  
Millet and District Museum – Tracey Leavitt  
Multicultural Heritage Centre – Judy Unterschultz, Scott Wnek  
Nina Hagerty Centre for the Arts – Wendy Hollo  
Northern Light Theatre – Mandelle Mudry  
Premier’s Council on Arts & Culture – John Short, Sherry Sewepagaham,  
Profiles Public Art Gallery – Frances Gagnon  
Strathcona County – Teresa Koslo  
Strathcona County Museums and Archives – Starr Hanson Iru Drefs  
Theatre Network – Jill Roszell  
Varscona Theatre – John Hudson

## ***Central Alberta***

ACFA Régionale de Red Deer – Nancy Desbiens  
Bashaw Historical Society – Leanne Walton, Pam Miller  
Canada’s Aviation Hall of Fame – Justin Cuffe  
Carstairs and District Historical Society – Jim Lorne  
Central Alberta Heritage Preservation Committee –Sheila Bannerman  
Central Alberta Presenters – Mary Hallett, W. Hallett  
City of Red Deer – Kristina Öberg  
Clearwater County – Joe Baker  
Danish Canadian Nation Museum – Larry Kjearsgarrrd, Faye Kjearsgarrrd  
Drayton Valley Historical Society – Bill Johanneson  
Innisfail and District Historical Society – Debbie Matthew  
Kelsey Community Society – Theo Thirsk  
Norwegian Laft Hus Society – Betty Wulff  
Premier’s Council on Arts & Culture – Angela Keibel  
Red Deer and District Archives – Janet Pennington  
Red Deer and District Community Foundation – Paul Harris  
Red Deer Chamber of Commerce – Danielle Klooster  
Red Deer College – Jason Frizzell, Joyce Howdle  
Red Deer Museum & Art Gallery – Lorna Johnson  
Red Deer South MLA– Cal Dallas  
Red Deer Symphony Orchestra – Jaquiline Brooks, Neil Evans  
Rosebud Theatre – Colin Jackson  
Town of Sundry – Bob McIntyre  
Tree House Youth Theatre – David Chapman

## ***Calgary and Area***

Alberta Association of Motion Picture and Television –  
Damien Petti  
Alberta Ballet – Chris George  
Art Gallery of Calgary – Molly Steeves

Calgary Arts Development Authority– Terry Rock  
Calgary Arts Resource Society – Brian Beaulieu, Graham Frampton  
Calgary Community Theatre – Sally Truss  
Calgary Contemporary Arts Society – Harry Kiyooka  
Calgary Economic Development/Film Commission – Luke Azevedo  
Calgary Heritage Initiative Society – Janet Woolgar  
Calgary-Mackay MLA – Teresa Woo-Paw  
Calgary Multicultural Centre – Anoush Newman  
Calgary Opera – Bob McPhee  
Calgary Stampede – Tracey Read  
Canotos Music Foundation – Andrew Mosker, Ric Singleton  
City of Airdrie – Lorri Laface, Glenda Alexander  
City of Calgary – Darryl Cariou  
Cricket Alberta – Gordon Oakes  
Decidedly Jazz Danceworks – Kathi Sundstrom  
EPCOR CENTRE – Sandra Gajic, Lisa Walli  
Front Row Centre Players – John Zeller, Janos Zeller  
Heritage Park – Alida Visbach  
IATSE Local 211 – Tom MacRae  
Lougheed House Conservation Society – Blane Hogue  
Mosaic Family Resource Centre – Wendy Auger, Wendy Fehr  
Premier’s Council on Arts & Culture – Amanda Affonso,  
Diane Jones Konihowski, Tom McCabe  
Pumphouse Theatre – Scott McTavish  
Rosebud Theatre – Bob Davis, Morris Entman, Colin Jackson  
Storybook Theatre – Tim Harris  
Theatre Junction – Carol Armes  
Town of Cochrane – Sandy Johnson  
Town of Okotoks – Sharon Hammersley, Andrea Spiers  
Vertigo Theatre – Suzanne Mott  
Visual Arts Centre – Greg Robb

### ***Southern Alberta***

Allied Arts Council of Lethbridge – Christopher Babits

Archaeological Society of Alberta – Judy Sturgeon

Cardston-Taber-Warner MLA – Broyce Jacobs

City of Lethbridge – Barbara Lacey

City of Medicine Hat Cultural Development – Carol Beatty

Empress Theatre – Terry Daniel

Fort Whoop Up National Historic Site – Doran Degenstein

Galt Museum & Archives – Susan Burrows-Johnson, Lucelle Prindle

Global Friendship Immigration Centre – Doreen Medway

Harcourt House Arts Centre/WECAN Society – Elizabeth M. Ginn

Lethbridge West MLA – Greg Weadick

Lethbridge East MLA – Bridget Pastoor

Lethbridge Symphony Association – Glenn Klassen

Premier’s Council on Arts & Culture – Brad Hembroff,

Southern Alberta Art Gallery – Marilyn Smith

Southern Alberta Ethnic Association – Surya Acharya

Town of High River – Sue Graham

University of Lethbridge – Fred Greene, Lisa Doolittle